

First Floor & Upper Level

First Floor & Upper Level
526.4 sqm Gross Internal
(excl. Hall)

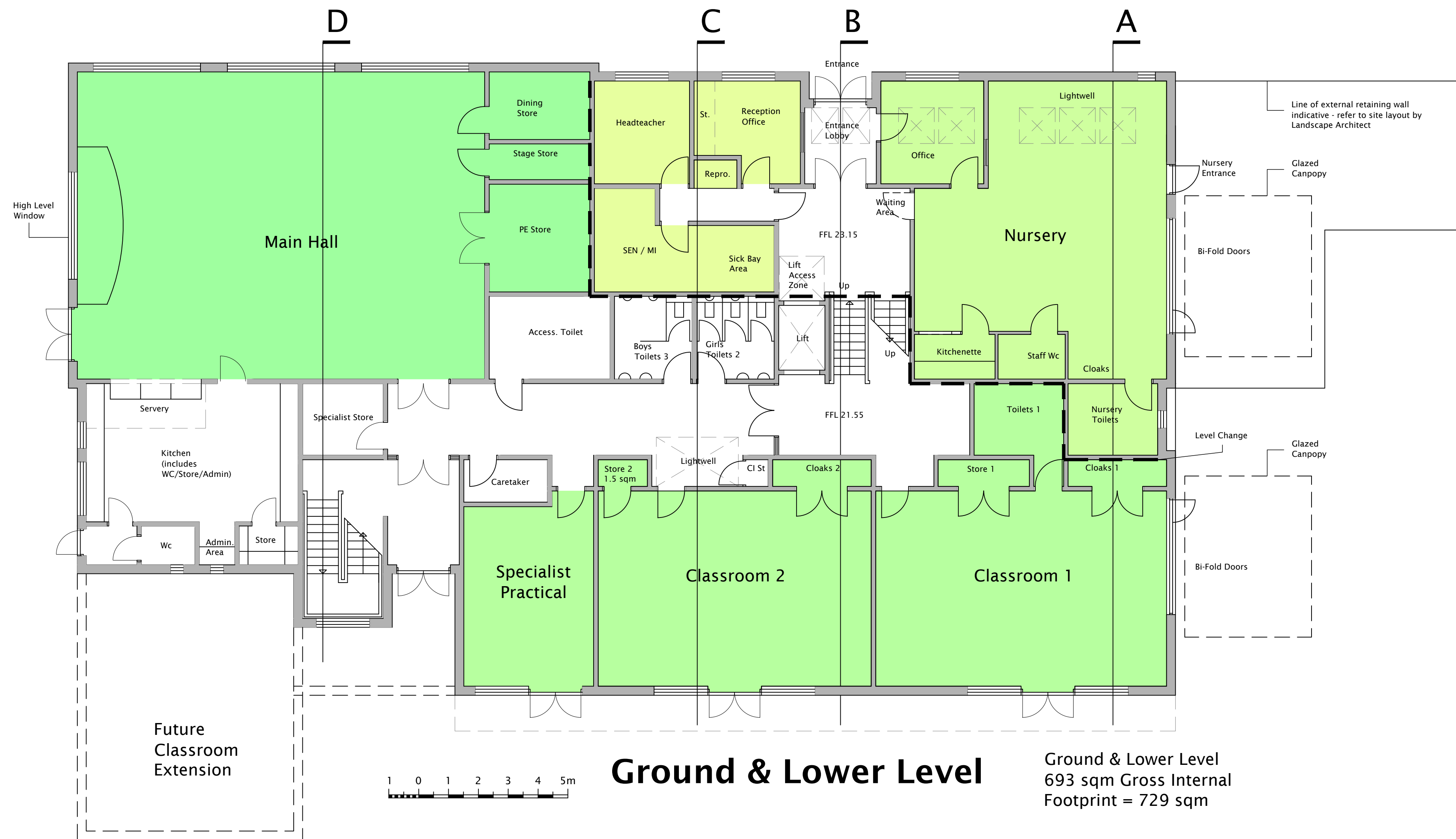

Ground & Lower Level

Ground & Lower Level
693 sqm Gross Internal
Footprint = 729 sqm

notes

revisions

rev.	date	description
------	------	-------------

PLANNING

burnsguthrie
and partners

11a calverley park
tunbridge wells
kent
tn11 2sj

tel: 01892 526377
fax: 01892 511979
e-mail:
enquiries@burns-guthrie.co.uk

job title:
**Hurst Green CoE
Primary School -
New School Proposals**

drawing title:
Proposed Plans

scale:
1:100@A1

drawn by:
JH

date:
8/5/09

drawing number:
2766/031

rev.: